

Harlequin Liberty Permanent Sprung Floor Panels

Specification Guide Harlequin Liberty Permanent Sprung Floor Panels

	Dimensions	Weight	Installed Thickness	Installation Times
Liberty Permanent	Full size panel 2.412m x 1.206m (95" x 47½")	36.5 kg (80 lbs)	37mm (1½")	Approx. 100 sq.m (120 sq.yd.) per day with 2 persons
	Half size panel 1.206m x 1.206m (47½" x 47½")			

Harlequin Liberty is a modular floor manufactured from engineered panels with elastomer blocks located at regular intervals on the underside. Panels are laid brickwork on the sub-floor so that cross-joins do not coincide. They are linked to each other by a radiussed tongue and groove pivot joint and secured by means of patented recessed metal clips, which removes the need to fix the panels mechanically to the sub-floor.

Permanent installation of Liberty panels.

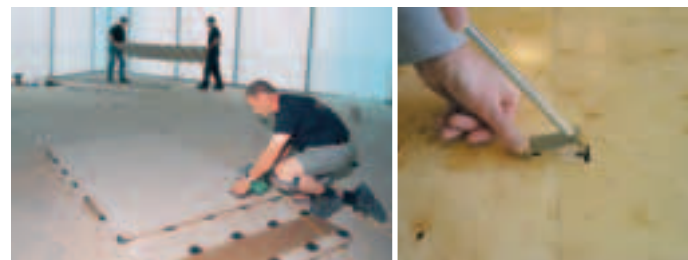

Inserting spring clip

Rolling out the dance floor.

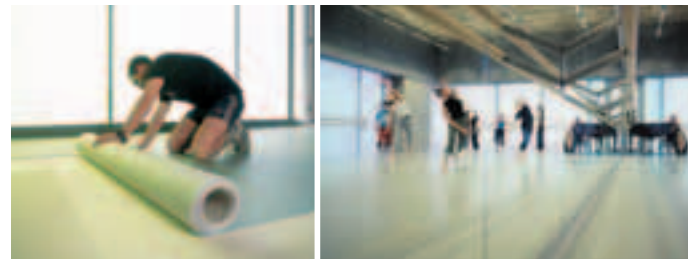

Installation of Liberty panels at Laban, London.

Panels layout

Liberty panels with Cascade surface at the Schweizerische Ballettberufsschule, Zürich, Switzerland

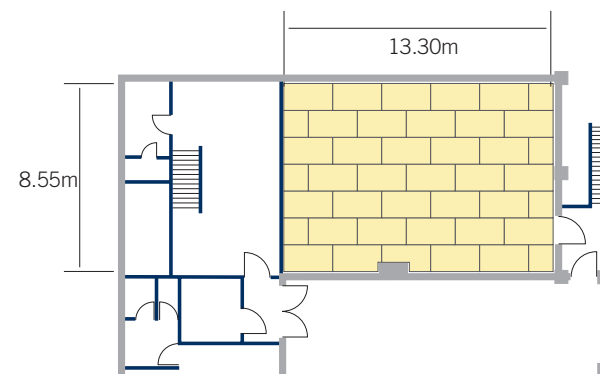

Harlequin Liberty Portable Sprung Floor Panels

Specification Guide Harlequin Liberty Portable Sprung Floor Panels

	Dimensions	Weight	Installed Thickness	Installation Times
Liberty Portable	Full size panel 2.412m x 1.206m (95" x 47½")	52 kg (114 lbs)	42mm (1⅝") plus the Harlequin floor	Approx. 50 sq.m. (60 sq.yd.) per hour with 2 persons
	Half size panel 1.206m x 1.206m (47½" x 47½")			

The Harlequin storage cart loaded with Liberty panels

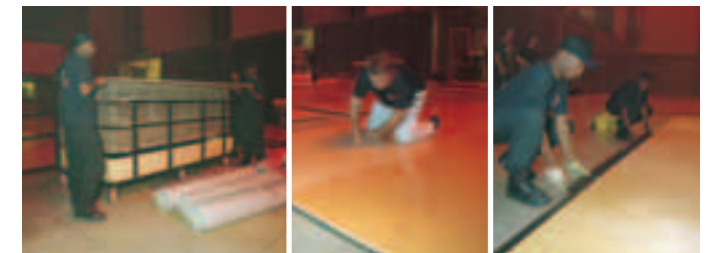

Installing the panels Fitting the edge trim

DIN STANDARD 18032 PART II Test Results Harlequin Liberty

	Shock Absorption	Vertical Deformation	Area Deflection	Rolling Load
Requirement	Min 53%	Min 2.3mm	Max 15%	Min 1500 N
Harlequin Liberty	67%	4.1mm	12.8%	> 1500 N

Standards and tests

Manufacturers are correctly required to ensure products perform to published specifications. At present there are no British standards specifically for dance floors that architects can work to. The absence of standards for dance floors was noted by the US-based organisation Entertainment Services Technical Association (ESTA) (www.esta.org) and a Working Group was set up to establish an international standard to be adopted by the American National Standards Institute (ANSI). The Working Group consists of manufacturers, end-users and specifiers and the Harlequin group is represented by its associate, American Harlequin Corporation. The new standard will be broadly based on the comprehensive German standard DIN 18032 part II, but modified to reflect the interests of dancers and related stage performers, and will provide protection to specifiers and manufacturers in the form of consensual test data.

Harlequin subjects its flooring products to tests by various international authorities covering, for example, physical and acoustic properties, resilience and slip resistance and test information specific to Harlequin floors is available from British Harlequin on request. All our sprung floors meet the relevant requirements of DIN 18032 part II and we will ensure compliance with the relevant sections of the new EN (European standard) for flooring. However, it cannot be assumed that if a product conforms to these standards it will automatically be approved by dancers, whose predilections vary.

British Harlequin plc
Festival House, Chapman Way
Tunbridge Wells, Kent TN2 3EF
Tel. 01892 514 888
Fax 01892 514 222
Freephone 0800 28 99 32
www.harlequinfloors.com
enquiries@harlequinfloors.com

Harlequin Europe SA
29, rue Notre-Dame
L-2240 Luxembourg
Tel. +352 46 44 22
Tel. FR +352 46 44 99
Tel. DE +352 46 39 39
Free phone 008 009 069 1000
Fax +352 46 44 40
www.harlequinfloors.com
info@harlequinfloors.com

American Harlequin Corporation
1531 Glen Avenue, Moorestown
NJ 08057, USA
Tel. +1 (1) 856 234 5505
Toll Free in USA 800 642 6440
Fax +1 (1) 856 231 4403
www.harlequinfloors.com
dance@harlequinfloors.com

Harlequin Australasia Pty Ltd.
PO Box 1028, 36A Langston Place
Epping, NSW 1710, Australia
Tel. +61 (2) 9869 4566
AUS Freecall 1300 666 900
Fax +61 (2) 9869 4547
www.harlequinfloors.com
contact@harlequinfloors.com

LONDON
LUXEMBOURG
LOS ANGELES
PHILADELPHIA
FORT WORTH
SYDNEY



HARLEQUIN
The world dances on Harlequin floors®

Sprung Floor Panel System

HARLEQUIN LIBERTY™

Uniclass L84621	EPIC E434
CI/SfB 52 (43) X	

Harlequin Liberty Permanent Sprung Floor Panels

Harlequin Liberty is a relatively “springy” floor, with good area elasticity. The foam blocks compress progressively under light and heavy loads, giving uniform and consistent shock damping and providing the same “feel” and energy return to one or several dancers on the same panel. The pivot joint extends along the panel edges to within 20mm of the corners ensuring the corners are protected from flexion under load and the edges are also carefully supported by elastomer blocks.

Harlequin Liberty panels are available in two versions: portable panels, which can be laid down to create a sprung floor and then taken up and moved to another venue or stored for future use; permanent panels, which have the advantage that they can be taken up and re-installed at another location or used in a different configuration if required.

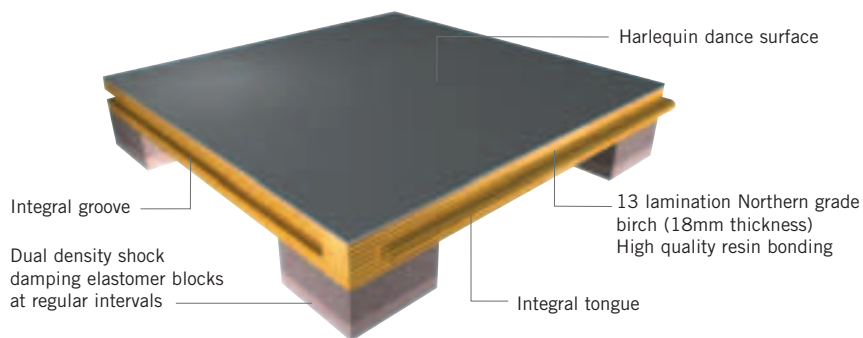

Harlequin Liberty Portable Sprung Floor Panels

Oil-tempered hardboard (Masonite) is attached to the underside of the portable panels to

- ease sliding of the panels into position
- protect the elastomer blocks
- allow the panels to be stacked more readily.

Edge trim and ramps are available for stage use or where the sprung floor does not extend to the walls of the studio. Harlequin Liberty portable panels are also available with matt black surface for stage use.

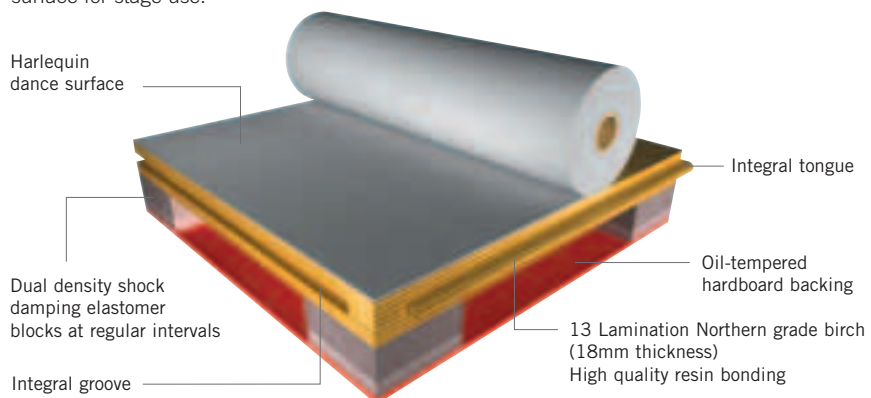

Photography:
Richard Dunkley
Dancers left to right:
Paulin Huguët & Roland Cox
Paulin Huguët & Roland Cox
Ana Lucia Alves
Femi Oyewole



Cart Specification

Unladen weight	370kg (814 lbs)
Capacity	20 full size panels or equivalent full and half size panels
Wheels	6 swivel, 4 corner wheels braked. Wheel diameter 152mm (6") Non-marking rims

Liberty - Portable Sprung Floor Panels Storage Cart

Harlequin Panel Storage Carts are designed to protect the Liberty panels and provide an easy and safe way of moving them from place to place, whether from stage to scenery dock or on and off vehicles when touring. Sturdily made of black scratch-resistant powder-coated steel, each cart is mounted on 6 swivel wheels with non-marking rims, the corner wheels having brakes.

The front gate of the cart is removable and the two sides hinge back fully to allow access to the cart from 3 sides. Panels are loaded in fives onto support bars, to prevent crushing the lower panels. Finally, the sides are hinged back into place, the front gate replaced and locked into position.

Each cart has a capacity of 20 full size Harlequin Liberty portable panels, with half size panels being loaded side by side. There is a removable storage box at the bottom of the cart for ramps and accessories.



Fully loaded cart with detachable front gate

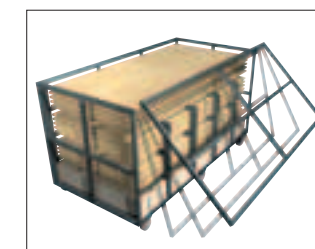

DISTRIBUTOR



11/07/BH001

2.1 Harlequin Liberty
2.1 Harlequin Liberty

HARLEQUIN
The world dances on Harlequin floors®



The Company reserves the right to make any variation in design or construction of the material described.

Guarantee

Harlequin™ and Liberty™ are trademarks of British Harlequin plc, American Harlequin Corporation and Harlequin Europe SA.

Country of origin: Made in the EU © British Harlequin plc, American Harlequin Corporation and Harlequin Europe SA. 2007