

## Harlequin Liberty Permanent Sprung Floor Panels

The unique feature of the blocks is their “dual density” (a sandwich of two different hardnesses tested by the Shore Durometer Test).

This provides progressive compression under light and heavy loads providing the same “feel” and energy return to one or several dancers on the same panel.

### Specification Guide Harlequin Liberty Permanent Sprung Floor Panels

	Dimensions	Weight	Installed Thickness	Installation Times
Liberty Permanent	Full size panel 96" x 48" (2.42m x 1.21m) Half size panel 48" x 48" (1.21m x 1.21m)	83 lbs (36.5 kg)	1 1/2" (37mm)	Approx. 120 sq.yd. (100 sq.m) per day with 2 persons

Permanent installation of Liberty panels.



Fitting at perimeter

Rolling out the dance vinyl



Installation of Liberty panels

### Panels layout

Liberty panels with Cascade surface

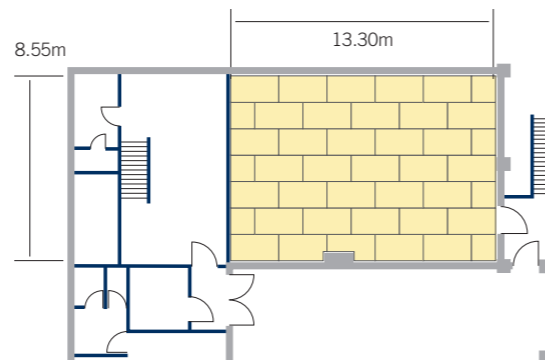

## Harlequin Liberty Portable Sprung Floor Panels

Harlequin Liberty sprung floor panels are available in both portable and permanent versions. Oil-tempered hardboard is attached to the underside of the portable panels. Edge trim and ramps are available for stage use or where the sprung floor does not extend to the walls of the studio. Harlequin Liberty portable panels are also available with matt black surface for stage use.

### Specification Guide Harlequin Liberty Portable Sprung Floor Panels

	Dimensions	Weight	Installed Thickness	Installation Times
Liberty Portable	Full size panel 96" x 48" (2.42m x 1.21m) Half size panel 48" x 48" (1.21m x 1.21m)	93 lbs (52 kg)	1 5/8" (42mm) plus the Harlequin floor	Approx. 60 sq.yd. (50 sq.m.) per hour with 2 persons



Installing the panels

Fitting the edge trim

### DIN STANDARD 18032 PART II Test Results Harlequin Liberty

	Shock Absorption	Vertical Deformation	Area Deflection	Rolling Load
Requirement	Min 53%	Min 2.3mm	Max 15%	Min 1500 N
Harlequin Liberty	67%	4.1mm	12.8%	> 1500 N

Harlequin Liberty is a modular floor manufactured from engineered boards with closed cell elastomer blocks on the underside to give uniform and consistent shock damping. The panels are laid brickwork fashion on the sub-floor so that cross-joins do not coincide. They are linked to each other by a radiused pivot joint.

**American Harlequin Corporation**  
1531 Glen Avenue  
Moorestown, NJ 08057, USA  
Tel. (856) 234 5505  
Toll Free (800) 642 6440  
Fax (856) 231 4403  
www.harlequinfloors.com  
dance@harlequinfloors.com

**British Harlequin plc**  
Festival House, Chapman Way  
Tunbridge Wells, Kent TN2 3EF  
England  
Tel. +44 (0)1892 514 888  
Fax +44 (0)1892 514 222  
Freephone 0800 28 99 32  
www.harlequinfloors.com  
enquiries@harlequinfloors.com

**Harlequin Europe S.A**  
29, rue Notre-Dame  
L-2240 Luxembourg  
Tel. (+352) 46 44 22  
Tel. FR (+352) 46 44 99  
Tel. DE (+352) 46 39 39  
Fax (+352) 46 44 40  
www.harlequinfloors.com  
info@harlequinfloors.com

**Harlequin Australasia Pty Ltd.**  
PO Box 1028, 36A Langston Place  
Epping, NSW 1710, Australia  
Tel. +61 (2) 9869 4566  
Fax +61 (2) 9869 4547  
AUS Freecall 1300 666 900  
www.harlequinfloors.com  
contact@harlequinfloors.com

Philadelphia  
London  
Paris  
Los Angeles  
Sydney  
Luxembourg  
Fort Worth



**HARLEQUIN**  
The world dances on Harlequin floors®

## Sprung Floor Panel System

# HARLEQUIN LIBERTY™

### Harlequin Liberty Permanent Sprung Floor Panels

The pivot joint extends along the panel edges to within 20mm of the corners ensuring the corners are protected from flexion under load. The edges are also carefully supported by elastomer blocks.

The unique feature of the blocks is their "dual density" (a sandwich of two different hardnesses tested by the Shore Durometer Test).

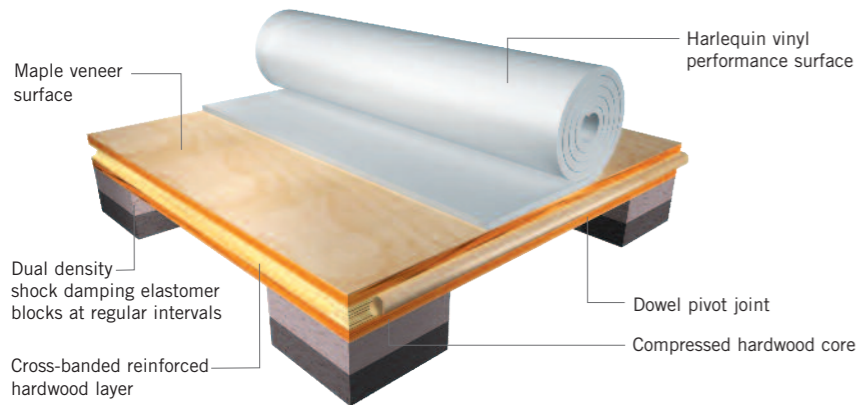

### Harlequin Liberty Portable Sprung Floor Panels

Harlequin Liberty sprung floor panels are available in both portable and permanent versions. Oil-tempered hardboard is attached to the underside of the portable panels to

- Ease sliding of the panels into position
- Protect the elastomer blocks
- Allow the panels to be stacked more readily.

Edge trim and ramps are available for stage use or where the sprung floor does not extend to the walls of the studio. Harlequin Liberty portable panels are also available with matt black surface for stage use.

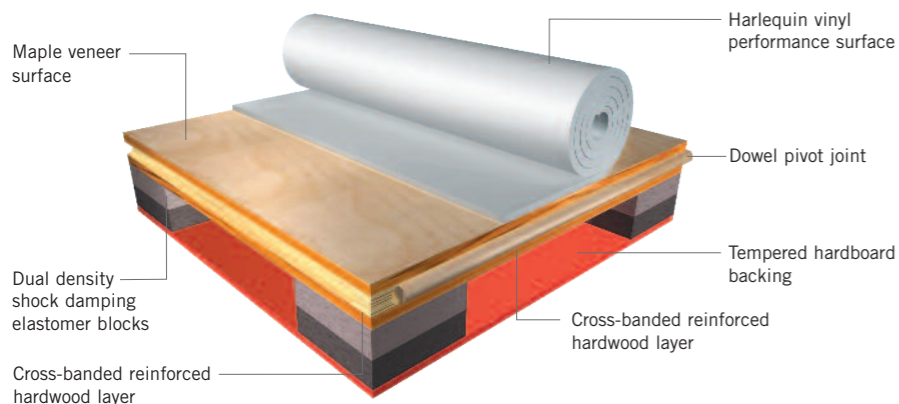

2.1 Harlequin Liberty

2.1 Harlequin Liberty

## Application Guide - Harlequin's Portable & Permanent Vinyl Floors

Available

REVERSIBLE	STUDIO	STUDIO 'B'	CASCADE	ALLEGRO	TEMPO	FIESTA	STANDFAST	MARINE
------------	--------	------------	---------	---------	-------	--------	-----------	--------

**Liberty Permanent**

**Liberty Portable**

**Activity**

**WoodSpring**

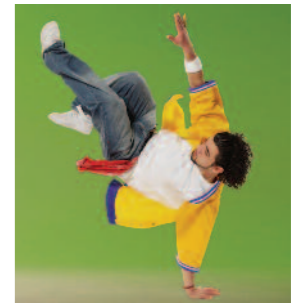

### Cart Specification

Unladen weight	400 lbs (370kg)
Capacity	20 full size panels or equivalent full and half size panels
Wheels	4 swivel, 4 corner wheels braked. Wheel diameter 6" (152mm) Non-marking rim

### Liberty - Portable Sprung Floor Panels Storage Cart

Harlequin Panel Storage Carts are designed to protect the Liberty panels and provide an easy and safe way of moving them from place to place, whether from stage to scenery dock or on and off vehicles when touring.

Sturdily made of black scratch-resistant powder-coated steel, each cart is mounted on 4 swivel wheels with non-marking rims, the corner wheels having brakes.

Each cart has a capacity of 20 full size Harlequin Liberty portable panels, with half size panels being loaded side by side.

In addition, there are 2 fork pockets under the cart to enable a fully-loaded cart to be handled by fork lift truck and the frame of the cart can readily be secured by straps when loading in a vehicle for road transport.

DISTRIBUTOR



01/08/AH021



**HARLEQUIN**  
The world dances on Harlequin floors®

